



**ROBINSONS**

## High Street

Dunstable, LU6 2HS

**£1,200 Per Month**

- AN EXCEPTIONAL PERIOD PROPERTY
- INFINITY LARGER THAN IT APPEARS
- A WELL-EQUIPPED FITTED KITCHEN
- CLOAKROOM WC
- 4-PIECE BATHROOM SUITE
- VERY DECEIVING PROPERTY
- RENOVATED/MODERNISED
- LIVING/DINING EXPERIENCE
- DOUBLE BEDROOM
- POPULAR VILLAGE LOCATION



1



1



1



E

**ROBINSONS**

Floor Plan

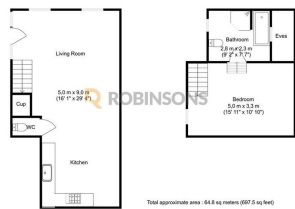

Floorplan produced by Microsoft Photography  
Floorplan is for illustrative purposes only and all measurements are approximate

Area Map



Energy Efficiency Graph

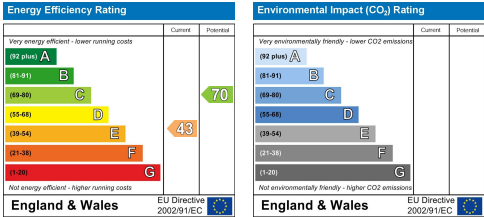

These particulars, whilst believed to be accurate are set out as a general outline only for guidance and do not constitute any part of an offer or contract. Intending purchasers should not rely on them as statements of representation of fact, but must satisfy themselves by inspection or otherwise as to their accuracy. No person in this firms employment has the authority to make or give any representation or warranty in respect of the property.

20 West Street, Dunstable,  
Bedfordshire, LU6 1SX

20 West Street, Dunstable,  
Bedfordshire, LU6 1SX

robinsons-estates.co.uk  
sales@robinsons-estates.co.uk